

REPAIR PARTS FOR MODEL 45-02381 BROADCAST SPREADER (TRACTOR MOUNT)

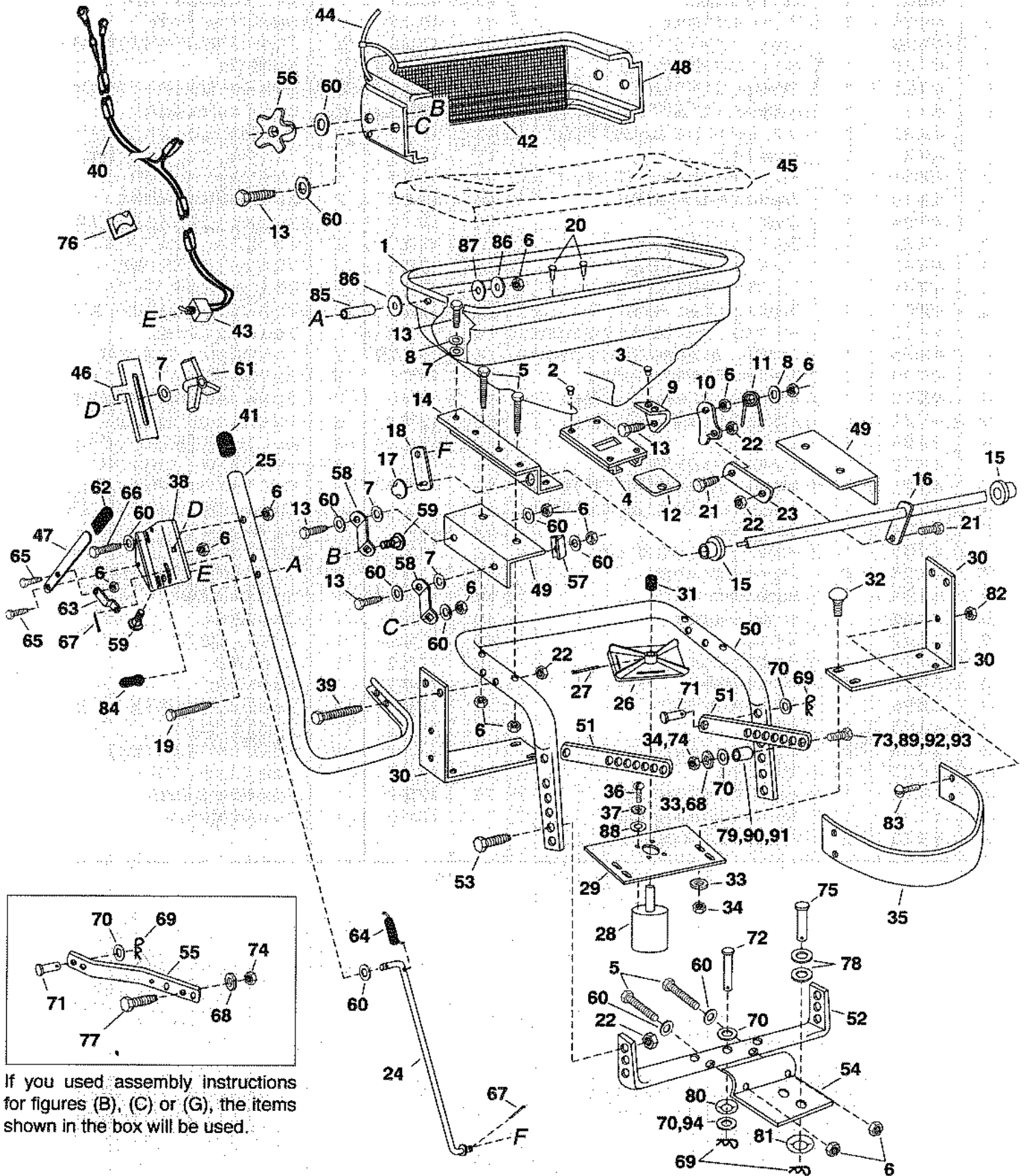

If you used assembly instructions for figures (B), (C) or (G), the items shown in the box will be used.

REPAIR PARTS FOR MODEL 45-02381 BROADCAST SPREADER (TRACTOR MOUNT)

REF NO.	PART NO.	QTY.	DESCRIPTION	REF NO.	PART NO.	QTY.	DESCRIPTION
1	44466	1	Hopper	50	46559	1	Tube, Frame
2	43882	4	Rivet, Stainless	51	23931	2	Strap, Mount Adjust
3	C-9M5732	2	Rivet, Pop	52	46560	1	Tube, Crossover
4	63081	1	Ass'y, Guide Closure	53	43063	4	Bolt, Hex 5/16-18 x 1" Lg. Gr. 5
5	1509-69	6	Bolt, Hex 1/4-20 x 1-3/4" Lg. Gr. 5	54	24135	1	Bracket, Hitch
6	43013	23	Nut, Hex Lock 1/4-20	55	24136	2	Bar, Hitch
7	1543-69	9	Washer, Nylon 21/64	56	46120	2	Knob, Plastic 1/4-20 Threads
8	43088	5	Washer, 1/4" Std. Wrt.	57	23999	2	Bracket, Angle Stop
9	23753	1	Bracket, Gate Slide Angle	58	23998	4	Bracket, Shield Swivel
10	23758	1	Bracket, Slide Gate	59	44950	3	Bolt, Carriage 1/4-20 x 3/4" Lg.
11	46312	1	Spring, Torsion	60	R19111116	19	Washer, 5/16" SAE
12	23533	1	Plate, Closure	61	43849	1	Knob, Plastic 1/4-20 Threads
13	43012	11	Bolt, Hex 1/4-20 x 3/4" Lg. Gr. 5	62	43848	1	Grip, Control Arm
14	24048	2	Bracket, Hopper Mounting	63	23756	1	Link, Flow Control
15	741-0248	2	Bearing, Flange	64	46317	1	Spring, Extension
16	63080	1	Ass'y, Flow Control Pivot Rod	65	43866	2	Bolt, Hex 1/4-20 x 5/8" Lg. Gr. 5
17	44166	1	Nut, Cap Push 1/2"	66	43648	2	Bolt, Hex 1/4-20 x 1-1/2" Lg. Gr. 5
18	24050	1	Link, Pivot Rod	67	44101	2	Pin, Cotter 3/32" x 3/4" Lg.
19	46071	1	Bolt, Hex 1/4-20 x 3-1/4" Lg.	68	43003	4	Lock Washer 3/8"
20	46454	2	Plug, Christmas Tree	69	43055	3	Hairpin Cotter 3/32"
21	43182	4	Bolt, Hex 5/16-18 x 3/4" Lg. Gr. 5	70	43070	5	Washer, 3/8" Std. Wrt.
22	43064	10	Nut, Hex Lock 5/16-18	71	45091	2	Pin, Clevis 3/8" x 1"
23	24051	1	Link, Pivot Rod	72	43023	1	Pin, Clevis 3/8" x 2"
24	46300	1	Rod, Flow Control	73	43084	2	Bolt, Hex 5/16-18 x 1-3/4" Lg. Gr. 5
25	46301	1	Control Tube	74	43015	4	Nut, Hex 3/8"
26	04367	1	Spreader Plate	75	44049	1	Pin, Clevis 1/2" x 1-1/4" Lg.
27	43010	1	Pin, Cotter 1/8" x 1-1/4" Lg.	76	46555	4	Wire Clip, Plastic
28	46562	1	Motor, 12 Volt	77	43001	4	Bolt, Hex 3/8-16 x 1" Lg. Gr. 5
29	24053	1	Plate, Motor Mount	78	R19171616	2	Washer 1/2"
30	24052	2	Bracket, Motor Mount	79	23228	4	Spacer, 3/4" Lg.
31	44688	1	Cap, Vinyl 3/4"	80	46556	1	Nut, Push 3/8"
32	43080	4	Bolt, Carriage 5/16-18 x 3/4" Lg.	81	46557	1	Nut, Push 1/2"
33	43086	6	Lock Washer 5/16"	82	43662	4	Nut, Hex 10-32 (SEMS)
34	43083	6	Nut, Hex 5/16"	83	43346	4	Bolt, Sl. Pan Hd. 10-32 x 5/8" Lg.
35	46303	1	Front Deflector	84	45082	1	Boot, Rubber Switch
36	46334	4	Bolt, Sl. Pan Hd. 8-32 x 1/2" Lg.	85	23906	1	Spacer, 1-9/16" Lg.
37	736-0722	4	Lock Washer 3/16"	86	43572	2	Washer, 1-1/2" O.D.
38	23754	1	Bracket, Flow Control Mount	87	43553	1	Washer, Nylon 1-1/2" O.D.
39	44180	4	Bolt, Hex 5/16-18 x 2" Lg. Gr. 5	88	43910	4	Washer, Flat #10 (3/16")
40	46554	1	Wire Harness	89	43432	2	Bolt, Hex 3/8-16 x 2-1/2" Lg.
41	44481	1	Cap, Vinyl 1"	90	23625	4	Pivot Bushing, 1/4" Lg.
42	46455	1	Sand Screen	91	23519	2	Spacer, 9/16" x 11/32" Lg.
43	46561	1	Switch, On - Off (Spring Loaded)	92	43062	2	Bolt, Hex 3/8-16 x 1-1/2" Lg.
44	726-0178	10	Tie, Nylon	93	43840	2	Bolt, Hex 5/16-18 x 1-1/4" Lg.
45	43962	1	Cover, Hopper Vinyl	94	43352	2	Flat Washer, 7/16"
46	23755	1	Gage, Flow Control		46740	1	Owners Manual
47	23759	1	Arm Flow Control				
48	46119	1	Deflector Shield				
49	23997	2	Bracket, Shield				