

12-5011
A25011
T66-3
50413
C2-5011

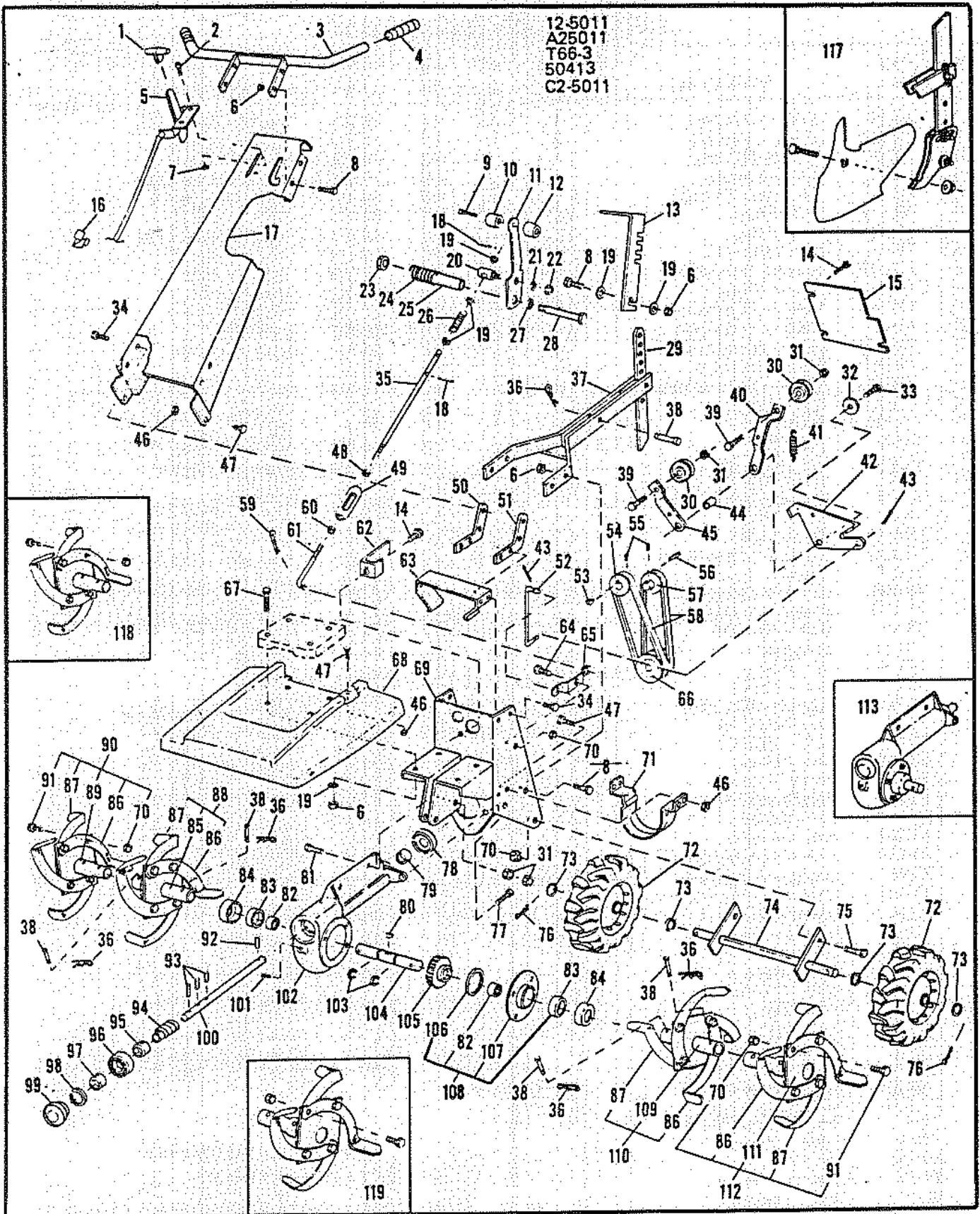

PARTS LIST FOR MODELS 12-5011, A25011, T66-3, 50413, C2-5011

Ref. No.	Part No.	Description	Qty.	Ref. No.	Part No.	Description	Qty.
1	46-36	Knob - Throttle	1	63	98-70	Retainer - Belt	1
2	20-236	Screw - Hex Hd	2	64	18-66	Bolt - Shoulder	1
3	4-169	Handle Bar Assy	1	65	79-155	Arm - Pivot	1
4	5-5	Grip - Handle	2	66	105-81	Pulley - Gear Box	1
5	8-86	Throttle Control	1	67	18-38	Bolt - Hex Hd	4
6	19-118	Nut - Hex	13	68	68-22	Hood - Tines	1
7	19-25	Nut - Hex	2	69	43-371	Main Support Assy	1
8	18-41	Bolt - Hex Hd	9	70	19-119	Nut - Hex	19
9	20-280	Screw - Round Hd	1	71	122-44	Belt Guard	1
10	46-40	Knob - Plain	1	72	3-165	Wheel Assy	2
11	108-69	Lever - Engagement	1	73	21-159	Washer - Flat	8
12	46-41	Knob - Threaded	1	74	66-63	Axle Assy	1
13	79-156	Arm - Wheel Adjusting	1	75	20-45	Bolt - Shoulder	2
14	20-131	Screw - Hex Hd	4	76	28-26	Cotter Pin	2
15	10-191	Cover - Main Support	1	77	20-189	Bolt - Thread Forming	2
16	17-131	Clip - Cable	1	78	74-14	Oil Seal	1
17	41-164	Panel Assy	1	79	11-17	Bearing - Sleeve	1
18	28-20	Roll Pin	2	80	16-3	Woodruff Key	1
19	21-62	Washer - Flat	9	81	20-157	Bolt - Hex Hd	2
20	35-8	Stud - Control	1	82	11-18	Bearing - Needle	2
21	21-13	Washer - Flat	1	83	74-15	Oil Seal	2
22	19-2	Nut - Hex	1	84	59-15	Shield - Bearing	2
23	19-139	Nut - Lock	1	85	89-30	Hub Assy - Inner R.H.	1
24	76-104	Spring - Comp. Short	1	86	84-8	Tine - Bolo L.H.	8
25	26-24	Spacer - Tubing	1	87	84-9	Tine - Bolo R.H.	8
26	76-105	Spring - Comp. Long	1	88	84-17	Inner Tine Assy R.H.	1
27	21-113	Washer - Curved	1	89	89-12	Hub Assy - Outer R.H.	1
28	18-44	Bolt - Hex Hd	1	90	84-12	Outer Tine Assy R.H.	1
29	136-11	Drag Bar	1	91	20-68	Bolt - Hex Hd	16
30	105-84	Idler Pulley	2	92	28-49	Roll Pin	1
31	19-111	Nut - Lock	6	93	28-23	Roll Pin	3
32	26-76	Spacer - Idler Arm	1	94	101-58	Worm	1
33	18-69	Bolt - Hex Hd	1	95	26-81	Spacer - Center-Worm	1
34	18-49	Bolt - Hex Hd	8	96	11-94	Bearing - Ball	1
35	82-134	Rod - Upper	1	97	26-82	Spacer - End-Worm	1
36	28-7	Cotter - Hairpin	6	98	98-49	Retaining Ring	1
37	7-346	Drag Bracket Assy	1	99	10-122	Plate - End Cover	1
38	28-6	Pin - Clevis	6	100	102-89	Shaft - Worm	1
39	20-151	Bolt - Hex Hd	2	101	114-5	Plug - Gear Box	1
40	79-110	Arm - Forward Idler	1	102	2-196	Housing - Gear	1
41	76-39	Spring - Extension	1	103	98-7	Retaining Ring	2
42	22-105	Plate - Idler Arms	1	104	102-88	Shaft - Output	1
43	28-16	Cotter Pin	2	105	101-57	Worm Gear	1
44	26-103	Spacer - Idler Arms	1	106	98-6	"O" Ring	1
45	79-151	Arm - Reverse Idler	1	107	10-121	Cover - Gear Housing	1
46	19-117	Nut - Hex	8	108	10-123	Housing Cover Assy	1
47	20-145	Bolt - Hex Hd	8	109	89-32	Hub Assy - Inner L.H.	1
48	19-24	Nut - Hex	1	110	84-18	Inner Tine Assy L.H.	1
49	19-83	Turnbuckle	1	111	89-16	Hub Assy - Outer L.H.	1
50	7-350	Bracket - Handle R.H.	1	112	84-13	Outer Tine Assy L.H.	1
51	7-349	Bracket - Handle L.H.	1	113	2-197	Gear Housing Assy	1
52	134-14	Link - Connecting	1				
53	16-9	Woodruff Key	1				
54	105-80	Pulley - Reverse	1				
55	20-255	Set Screw - Pulley	4				
56	16-7	Key - Square	1				
57	105-61	Pulley - Forward	1				
58	107-37	Belt "V"	2				
59	28-77	Cotter - Hairpin	1	117	23-54	Furrowing Kit	1
60	19-136	Nut - L.H. Thread	1	118	84-14	Tine Extension R.H.	1
61	82-141	Rod - Lower	1	119	84-15	Tine Extension L.H.	1
62	122-73	Belt Guide	1		84-16	Tine Extension Kit L.H. & R.H. (Includes Ref. No. 118 & 119)	1

OPTIONAL ACCESSORIES

WHEN ORDERING PARTS, USE PART NO. ONLY, NOT REF. NO.