

3C-6
3C-7
3C-8
12-3100
44-03388

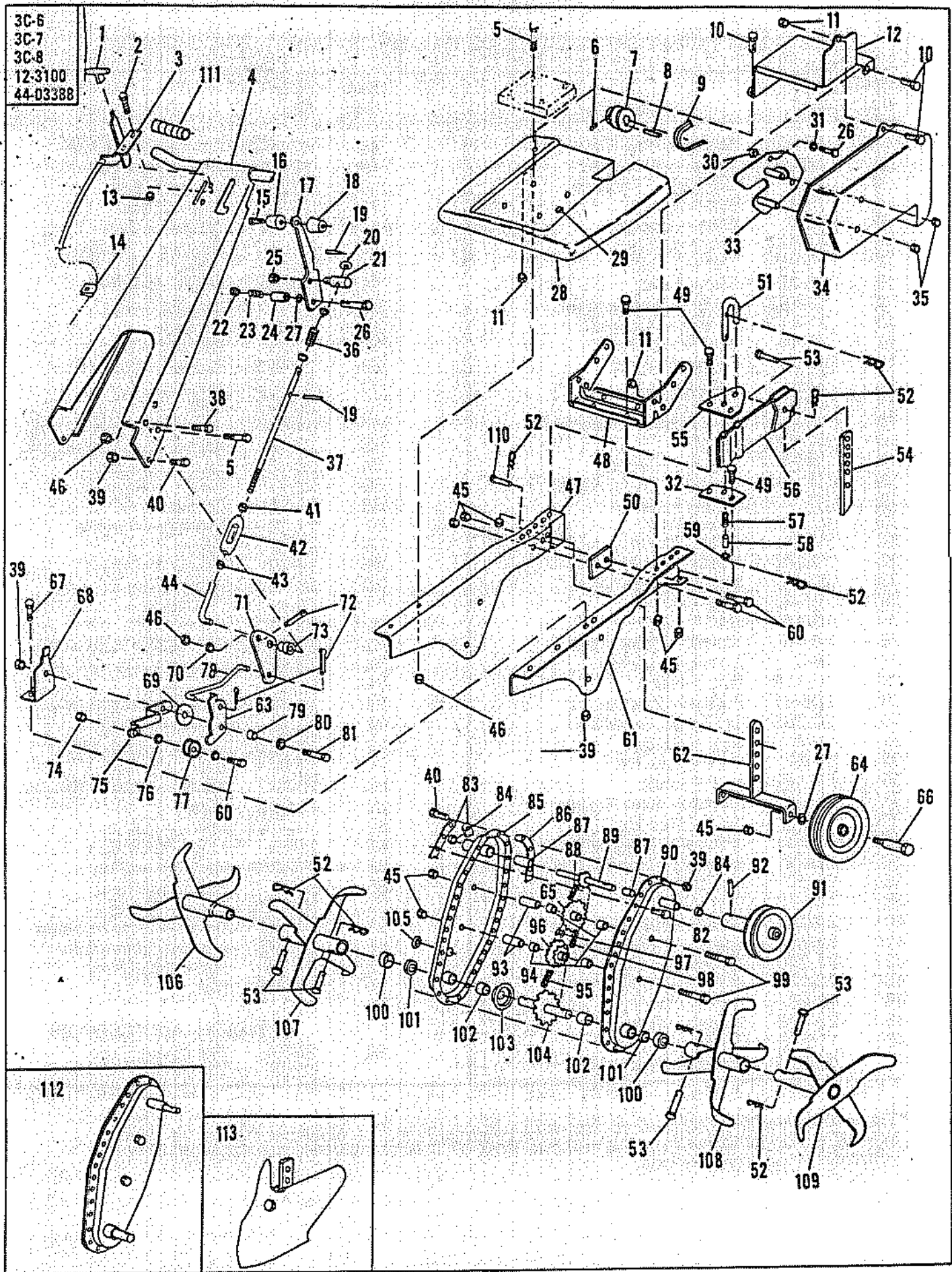

PARTS LIST FOR MODELS 3C-6, 3C-7, 3C-8, 12-3100 & 44-03388

Ref. No.	Part No.	Description	Ref. No.	Part No.	Description
1	46-36	Knob - Black	59	21-203	Washer - Wheel & Pivot Adj.
2	20-282	Screw - Hex	60	20-67	Bolt - Hex
3	8-86	Control Throttle	61	163-1	Beam - Main Supt. L.H.
4	41-180	Panel Assy.	62	7-384	Wheel Brkt. Assy.
5	18-43	Bolt - Hex	63	22-117	Plate - Idler Pivot
6	20-297	Set Screw	64	3-90	Wheel - 8"
7	105-98	Forward Pulley	65	135-47	Sprocket Assy. - Upper
8	16-7	Key	66	20-74	Bolt - Axle
9	107-38	Belt	67	18-3	Bolt - Hex
10	18-110	Bolt	68	7-389	Brkt. - Idler Mtg.
11	19-2	Nut - Keps	69	21-158	Washer
12	10-213	Cover - Handle Brace	70	21-74	Washer
13	19-1	Nut - Keps	71	22-123	Bellcrank - Control Plate
14	17-131	Clip - Tinnermann	72	28-16	Cotter Pin
15	20-280	Bolt - Phillips	73	26-124	Spacer - Bellcrank
16	46-40	Knob - Plain	74	19-111	Nut - Jam
17	108-69	Lever - Engagement	75	79-164	Arm - Fwd. Idler
18	46-41	Knob - Thread	76	21-33	Washer 5/16 Flat
19	28-20	Pin	77	105-87	Idler Pulley Assy.
20	21-62	Washer 5/16 SAE	78	82-147	Rod - Control Idler
21	35-8	Stud Control	79	26-103	Spacer
22	19-139	Nut - Flange	80	21-74	Washer
23	76-104	Spring	81	20-46	Bolt - Hex Hd.
24	26-24	Spacer	82	20-305	Bolt - Thread Form.
25	19-139	Nut-Flange	83	112-48	Strap - Nut Plate
26	18-44	Bolt - Hex	84	74-29	Seal - Input Shaft
27	21-113	Washer - Curved	85	128-42	Transmission Weld Assy. R.H.
28	68-24	Tine Hood Assy.	86	58-17	Gasket - Transmission Housing
29	161-1	Protective Pad	87	11-156	Bearing - Input Shaft
30	26-129	Spacer	88	110-49	Chain Roller No. 35
31	21-14	Washer - 1/2 Lock	89	102-144	Shaft Assy. - Input
32	22-119	Plate - Bottom Drag Brkt.	90	128-41	Transmission Weld Assy. L.H.
33	22-126	Belt Guide Plate Assy.	91	105-99	Pulley Assy.
34	10-214	Guard - Belt	92	28-88	Roll Pin
35	19-194	Nut - Flange	93	13-15	Sleeve - Bearing
36	76-105	Spring	94	11-155	Bearing - Needle Sprocket
37	82-146	Rod - Control Upper	95	110-51	Chain Roller No. 50
38	18-5	Bolt - Hex	96	135-45	Sprocket Assy. - Lower
39	19-117	Nut - Eslock	97	110-31	Master Link No. 420
40	20-145	Bolt - Hex	98	110-50	Chain Roller No. 420
41	19-24	Nut	99	20-303	Bolt - Hex
42	19-83	Turnbuckle	100	59-19	Cover - Tine Hub Seal
43	19-136	Nut-L.H. Thd	101	74-15	Seal - Output Shaft
44	82-141	Rod - Lower	102	11-18	Bearing - Needle
45	19-119	Nut - Eslock	103	26-122	Spacer - Tine Shaft
46	19-118	Nut - Eslock	104	102-147	Shaft Assy. - Output
47	163-2	Beam - Main Supt. R.H.	105	114-24	Plug - Oil Fill
48	164-1	Channel - Handle Supt.	106	84-69*	Outer Tine Assy. R.H.
49	20-108	Bolt - Hex Hd.	107	84-68*	Inner Tine Assy. R.H.
50	26-123	Spacer - Main Supt. Beam	108	84-64	Inner Tine Assy. L.H.
51	28-115	Pin - Drag Brkt.	109	84-66	Outer Tine Assy. L.H.
52	28-7	Hairpin Cotter	110	28-117	Pin - Clevis
53	28-6	Pin - Clevis	111	5-5	Grip
54	136-11	Drag Bar	112	128-43	Transmission Assy.
55	22-118	Plate - Top Drag Brkt.			
56	7-390	Drag Brkt. Assy.			
57	76-118	Spring - Wheel & Pivot Adj.			
58	26-128	Spacer - Wheel & Pivot Adj.	113	23-54	OPTIONAL ACCESSORIES Furrowing Tool

*These tine assemblies are symmetrical with left hand side. For staggered tines, order 84-65 Inner R.H., 84-67 Outer R.H. Symmetrical tines are interchangeable with staggered only if you change the complete side.