

B2-3011
C2-3011
MH-36
12-3011
33-6
33-7
33-8

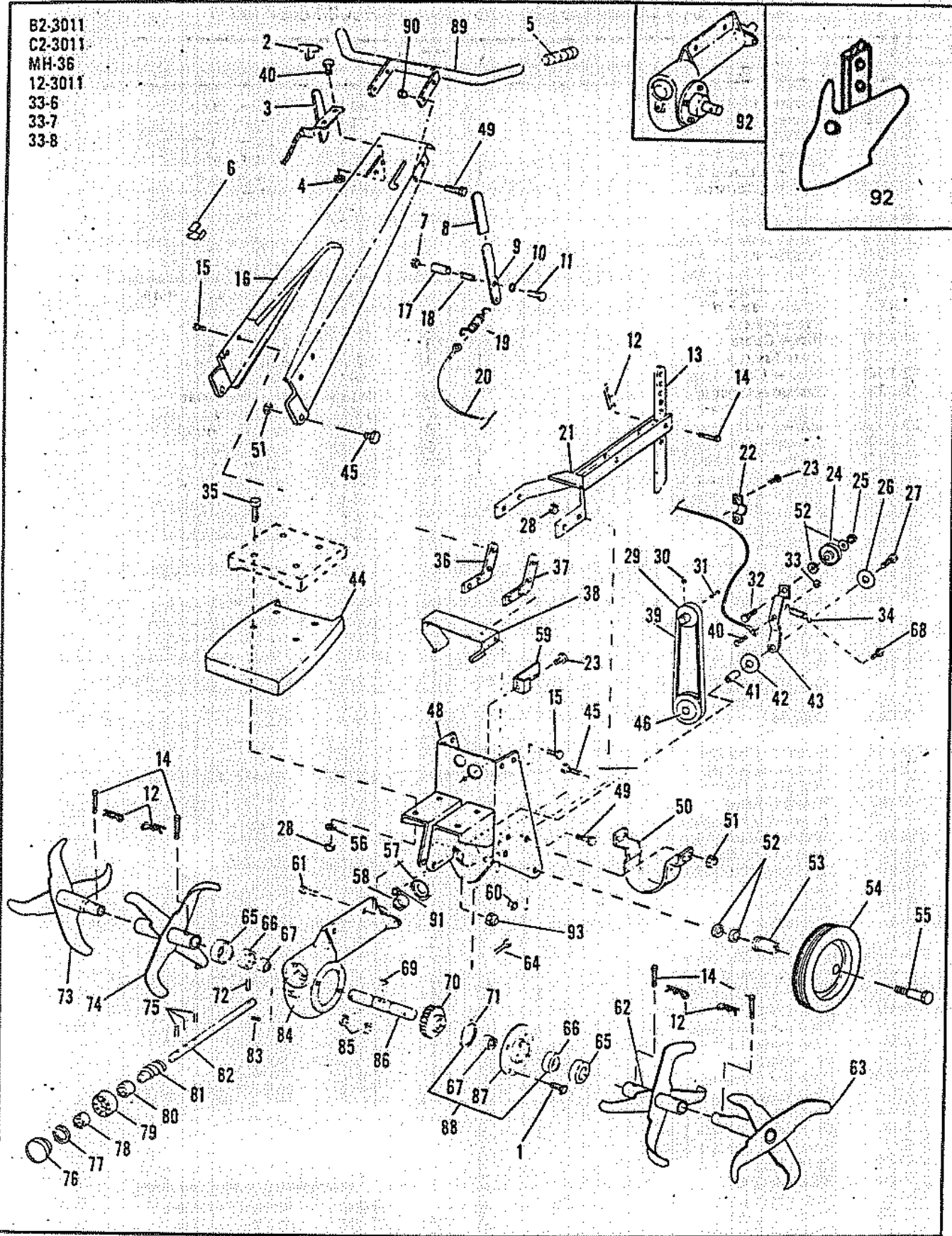

PARTS LIST FOR MODELS B2-3011, C2-3011, MH-36, 12-3011, 33-6, 33-7 & 33-8

Ref. No.	Part No.	Description	Ref. No.	Part No.	Description
1	18-88	Screw - Hex Hd	48	43-372	Main Support Assy
2	46-36	Knob - Throttle	49	18-41	Bolt - Hex Hd
3	8-85	Control - Throttle	50	122-44	Guard - Belt
4	19-1	Nut - Hex	51	19-117	Nut - Lock
5	5-5	Grip - Handle	52	21-33	Washer - Flat
6	17-131	Clip - Cable	53	11-117	Bearing - Wheel
7	19-139	Nut - Lock	54	3-90	Wheel Assy - 8"
8	56-18	Tip - Lever	55	20-74	Bolt - Shoulder
9	108-67	Lever - Engagement	56	21-62	Washer - Flat
10	21-113	Washer - Curved	57	74-14	Oil Seal
11	18-44	Bolt - Hex Hd	58	11-17	Bearing - Sleeve
12	28-7	Cotter Hairpin	59	122-73	Guide - Belt
13	136-11	Drag Bar	60	19-119	Nut - Lock
14	28-6	Pin - Clevis	61	20-157	Bolt - Hex Hd
15	18-49	Bolt - Hex Washer Hd	62	84-64	Inner Tine Assy - L.H.
16	41-189	Panel	63	84-66	Outer Tine Assy - L.H.
17	26-24	Spacer - Tubing	64	20-156	Bolt - Hex Hd
18	76-104	Spring - Compression	65	59-15	Shield - Bearing
19	76-111	Spring - Cable	66	74-15	Oil Seal
20	47-538	Cable Assy	67	11-18	Bearing - Needle
21	7-371	Drag Bracket Assy	68	20-277	Screw
22	122-45	Guide - Cable	69	16-39	Key - Woodruff
23	20-131	Screw - Hex Hd	70	101-90	Worm Gear
24	105-87	Idler Pulley	71	98-6	"O" Ring
25	19-111	Nut - Lock	72	28-49	Pin - Roll
26	26-76	Spacer - Idler Arm	73	84-69*	Outer Tine Assy - R.H.
27	18-3	Screw - Hex Hd	74	84-68*	Inner Tine Assy - R.H.
28	19-118	Nut - Hex	75	28-88	Pin - Roll
29	105-61	Pulley - Engine	76	10-122	Plate - End Cover
30	20-255	Set Screw - Pulley	77	98-49	Retaining Ring
31	16-7	Key - Square	78	26-120	Spacer - End, Worm
32	20-67	Bolt - Hex Hd	79	11-94	Bearing - Ball
33	19-141	Nut - Lock	80	26-81	Spacer - Center, Worm
34	76-96	Spring - Arm Return	81	101-86	Worm
35	18-38	Bolt - Hex Hd	82	102-141	Shaft - Worm
36	7-350	Bracket - Handle R.H.	83	114-5	Plug - Gear Box
37	7-349	Bracket - Handle L.H.	84	2-196 B	Housing - Gear
38	98-70	Belt Retainer	85	98-7	Retaining Ring
39	107-37	Belt - V	86	102-148	Shaft - Output
40	20-282	Screw - Hex Hd	87	10-121	Cover - Gear Housing
41	26-75	Spacer - Idler Arms	88	10-123	Housing Cover Assy
42	21-158	Washer - Spacer	89	4-198	Handle Bar Assy
43	79-110	Arm - Idler Mounting	90	19-118	Nut
44	68-20	Hood - Tines			
45	20-145	Screw - Hex Hd			
46	105-65	Pulley - Driven			
47	2-222	Housing Assy - Gear			
					OPTIONAL ACCESSORIES
			92	23-54	Furrowing Tool
				129-8	Worm Gear Oil - 8 oz.

*These tine assemblies are symmetrical with left hand side. For staggered tines, order 84-65 Inner R.H., 84-67 Outer R.H. Symmetrical tines are interchangeable with staggered only if you change the complete side.