

B1-2259
11-2259
50534
50536

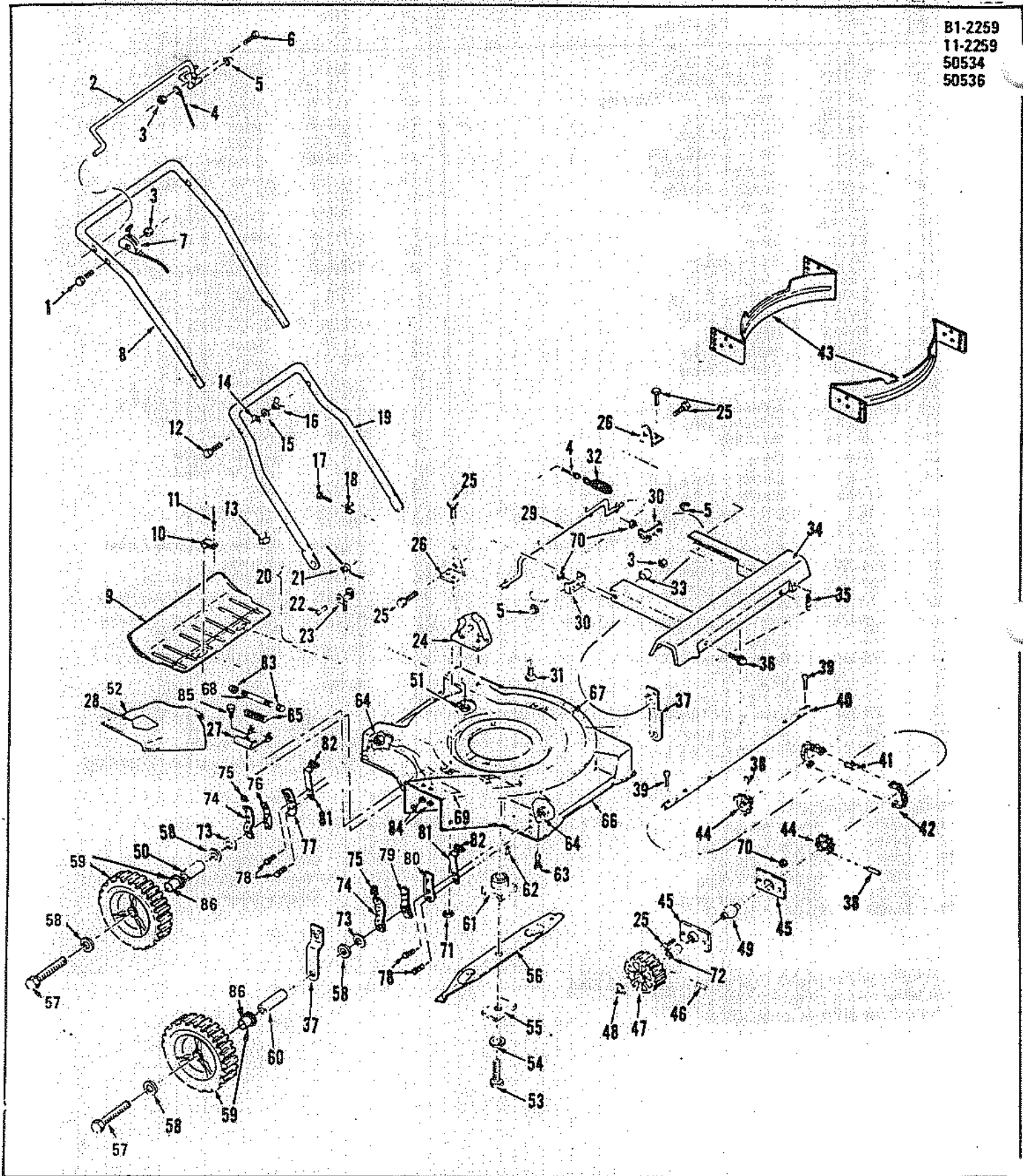

PARTS LIST FOR MODELS B1-2259, 11-2259, 50534 & 50536

Ref. No.	Part No.	Description	Ref. No.	Part No.	Description
1	18-18	Bolt - 1/4-20 x 1-1/2	45	22-145	Plate - Bearing
2	4-221	Handle Weldment	46	28-23	Pin - Roll
3	19-117	Nut - Hex 1/4-20 Locking	47	101-84	Pinion - Drive
4	47-580	Cable - Drive	48	21-21	Washer - Flat
5	19-208	Nut - 3/8 Push	49	11-145	Bearing
6	18-3	Bolt - 1/4-20 x 3/4	50	*26-146	Spacer - Wheel
7	8-91	Control - Throttle	51	19-3	Nut - 5/16
8	4-222	Handle - Folding	52	22-159	Deflector - Hinged
9	10-234	Trailguard	53	18-36	Bolt - Blade
10	17-143	Clip	54	21-18	Washer - Blade
11	62-34	Rivet	55	26-97	Spacer - Adapter
12	18-131	Bolt - Handle	56	1-111	Blade - 22"
13	17-2	Clamp - Cable	57	*20-320	Bolt - 3/8-16 x 2-1/8
14	21-191	Washer - Curved	58	21-33	Washer - 3/8 Flat
15	21-197	Washer - Lock	59	*3-168	Wheel - 8"
16	19-183	Nut - Wing	60	*26-147	Spacer - Wheel
17	20-195	Screw - Casing	61	15-21	Adapter - Blade
18	17-80	Clamp - Casing	62	16-1	Key
19	6-62	Yoke	63	20-156	Bolt - Engine
20	105-88	Clevis Assembly	64	19-147	Nut - Axle
21	105-82	Pulley - Cable	65	76-146	Spring - Deflector Return
22	28-110	Pin - Roll	66	2-234	Housing
23	6-56	Clevis	67	54-326	Decal - "Place Foot..."
24	7-364	Bracket - Yoke, L.H.	68	28-141	Pin - Deflector Hinge Pivot
	7-365	Bracket - Yoke, R.H.	69	54-387	Decal - Caution
25	18-1	Bolt - 1/4-20 x 5/8	70	19-2	Nut - 1/4-20 Keps
26	7-245	Bracket - Pinion Tube	71	19-139	Nut - 1/4-20 Flange
27	7-473	Bracket - Deflector	72	26-155	Spacer
28	54-542	Decal - Danger	73	21-113	Washer - Spring
29	82-161	Rod - Engagement	74	76-109	Spring
30	7-433	Bracket - Hinge	75	137-13	Tip - Q.W.A.
31	20-186	Bolt - 1/4-20 x 1/2	76	7-380	Bracket - Q.W.A., RR & LF
32	76-147	Spring - Lever Arm	77	12-178	Plate - Mounting, RR & LF
33	26-150	Spacer - Pivot	78	20-294	Bolt - 3/8-16 x 5/8
34	10-242	Cover - Pinion	79	7-379	Bracket - Q.W.A., LR & RF
35	76-133	Spring - Extension	80	12-179	Plate - Mounting, LR & RF
36	20-329	Screw - 1/4-20 x 5/8	81	7-372	Bracket - Saf-T-Lift
37	79-185	Arm - Actuated	82	137-14	Tip - Saf-T-Lift
38	28-50	Pin - Roll 3/16 x 1	83	19-213	Nut - Acorn Push
39	28-26	Pin - Cotter 1/8 x 1	84	19-117	Nut - Eslock
40	102-164	Shaft - Pinion	85	20-145	Screw - Hex Hd.
41	110-39	Master Link	86	11-117	Bearing (50536 Only)
42	110-48	Chain			
43	22-149	Baffle			
44	135-24	Sprocket - Drive			

OPTIONAL ACCESSORY

- 30-0215 Grass Catcher
- 30-0265 Replacement Bag for 30-0215

*Model 50536 Only.

- 50 26-147 Spacer - Wheel
- 57 20-303 Bolt - Front Only
- 59 3-106 Wheel - 8"
- 60 26-148 Spacer - Wheel