

A1-2152
10 ASP215
11-2152

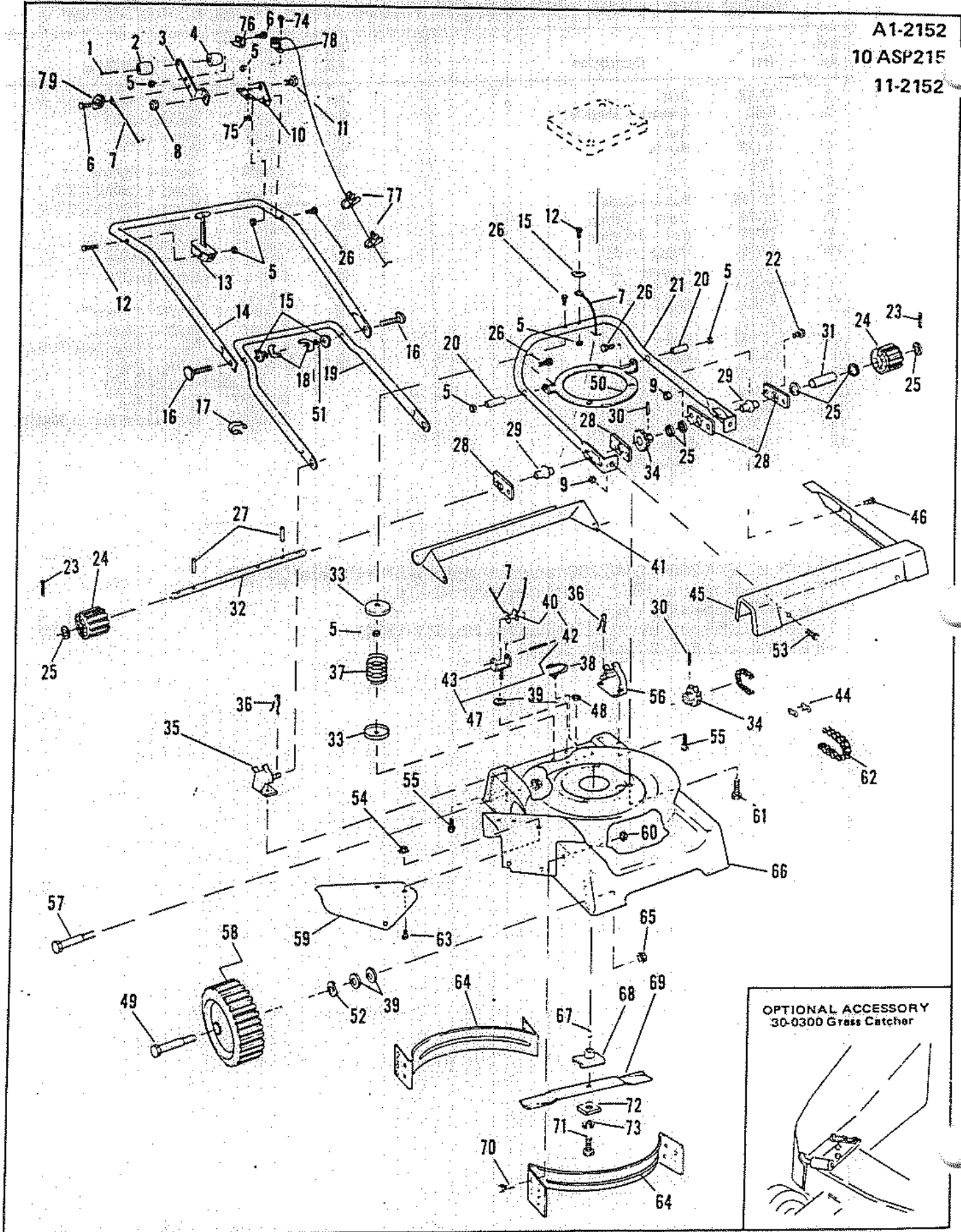

PARTS LIST FOR MODELS A1-2152, 10 ASP215, & 11-2152

Ref. No.	Part No.	Description	Ref. No.	Part No.	Description
1	20-280	Screw - Shift Lever	41	10-188	Guard - Trailing
2	46-40	Knob - Plain	42	28-110	Pin - Roll
3	108-68	Lever - Shift	43	6-56	Clevis
4	46-41	Knob - Thread	44	110-39	Master Link
5	19-117	Nut	45	10-196	Cover - Chain
6	20-145	Screw	46	20-287	Screw
7	47-544	Cable	47	105-83	Pulley Assy
8	19-111	Nut	48	19-3	Nut
9	19-2	Nut - Keys	49	18-116	Bolt - Axle
10	7-352	Bracket - Shift Lever	50	26-109	Spacer - Engine
11	18-60	Bolt - Shoulder	51	21-197	Washer
12	18-18	Bolt	52	21-113	Washer - Curved
13	8-91	Control - Throttle	53	18-3	Screw
14	4-175	Handle	54	19-1	Nut - Keys
15	21-191	Washer - Curved	55	20-288	Screw
16	18-131	Bolt - Curved Hd	56	7-364	Bracket - Yoke, L.H.
17	17-2	Clamp - Cable	57	20-74	Bolt - Axle
18	19-183	Nut - Wing	58	3-168	Wheel Assy
19	6-63	Yoke	59	130-20	Chute Extension
20	26-115	Spacer - Pivot	60	19-147	Nut
21	25-88	Tube - Pinion	61	18-130	Bolt - Hex Hd
22	18-1	Bolt - Bearing Plate	62	110-46	Chain
23	28-26	Pin - Cotter	63	18-127	Bolt - Carriage
24	101-84	Pinion	64	22-74	Baffle
25	21-120	Washer	65	19-146	Nut
26	18-42	Bolt	66	2-186	Housing
27	28-23	Pin - Roll	67	16-1	Key - Engine Shaft
28	12-165	Plate - Bearing	68	15-21	Adapter - Blade
29	11-145	Bearing	69	1-110	Blade
30	28-50	Pin - Roll	70	20-240	Screw
31	26-107	Spacer - Pinion, L.H. (Drive Side)	71	18-36	Bolt
32	102-137	Shaft	72	26-97	Spacer - Blade Adapter
33	80-11	Cup - Spring	73	21-18	Washer - Lock
34	135-24	Sprocket	74	20-282	Bolt Hex Hd
35	7-365	Bracket - Yoke, R.H.	75	19-141	Nut
36	17-107	Clip - Yoke	76	7-376	Bracket - Magnet
37	76-107	Spring	77	72-6	Tie - Wire
38	17-137	Clamp - Wire	78	9-58	Module - Safet / Interlock
39	21-33	Washer	79	21-1	Washer
40	105-82	Pulley - Control Cable			

OPTIONAL ACCESSORIES

- 30-0300 Grass Catcher
- 30-0350 Replacement bag for 30-0300