

B1-2252
 C1-2252
 10ASP216
 11-2252

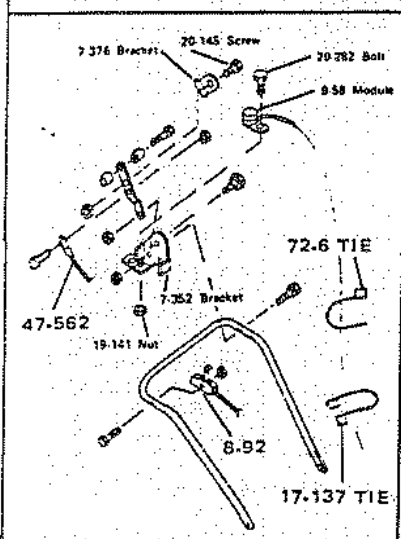
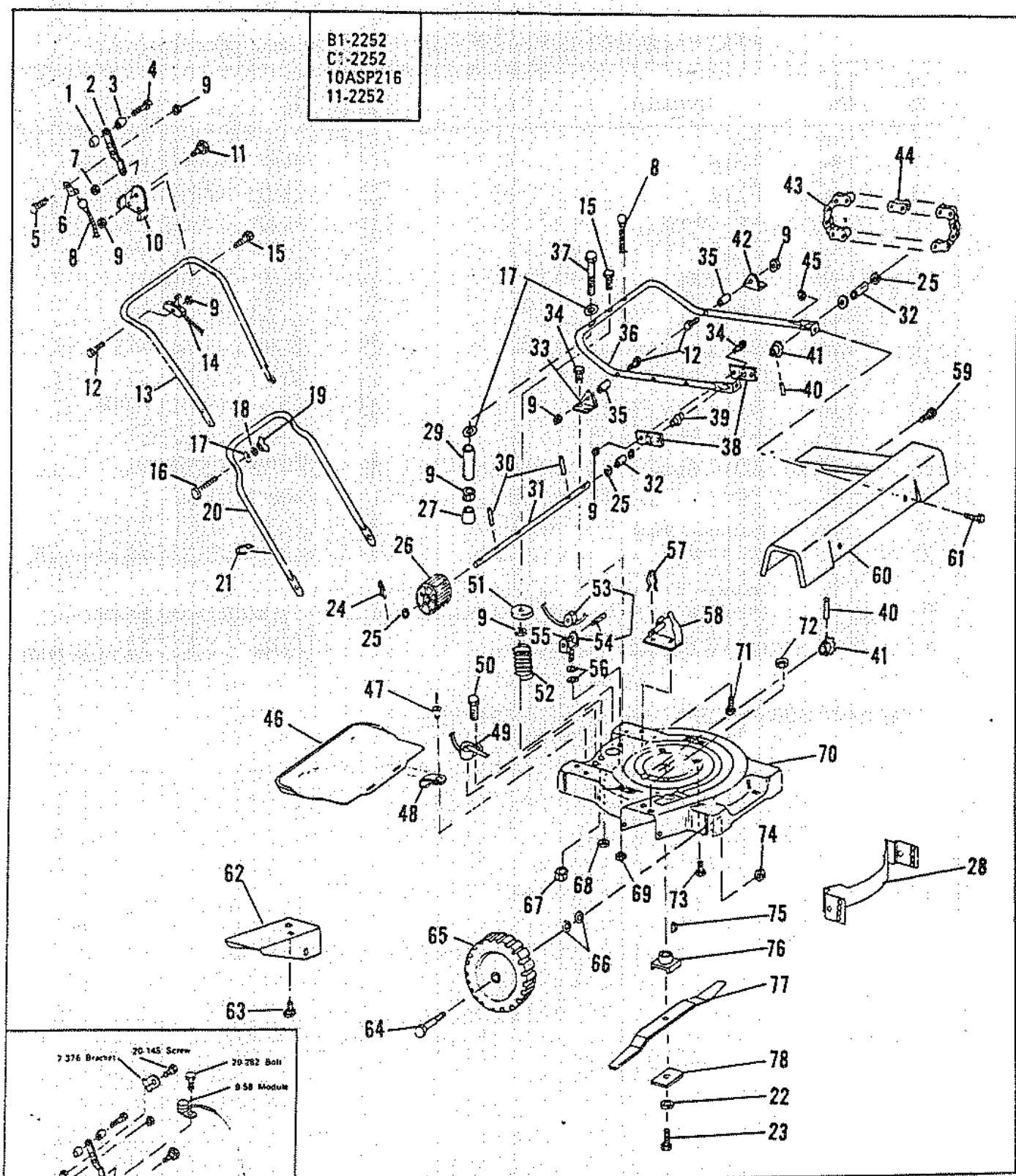

PARTS LIST FOR MODELS B1-2252, C1-2252, 10ASP216 & 11-2252

Ref. No.	Part No.	Description	Ref. No.	Part No.	Description
1	46-41	Knob - Tapped	41	135-24	Sprocket
2	108-68	Lever Shift	42	7-382	Bracket - L.H.
3	46-40	Knob - Plain	43	110-48	Chain
4	20-280	Screw	44	110-39	Master Link
5	20-145	Screw	45	19-2	Nut - Keps
6	28-118	Clevis - Lanyard	46	10-207	Trail Guard
7	19-111	Nut	47	62-34	Pop Rivet
8*	47-572	Cable - Shift	48	17-143	Bracket
9	19-117	Nut	49*	9-60	Module
10*	7-398	Bracket - Shift Lever	50	20-282	Bolt
11	18-60	Bolt - Shoulder	51	80-11	Cup - Spring
12	18-18	Bolt	52	76-114	Spring
13	4-175	Handle	53	105-82	Pulley
14*	8-91	Throttle Control	54	105-83	Pulley Assy.
15	18-42	Bolt	55	6-56	Clevis
16	18-131	Bolt - Curved Head	56	21-33	Washer
17	21-191	Washer - Curved	57	17-107	Clip - Yoke
18	21-197	Washer - Lock	58	7-365	Bracket - Yoke R.H.
19	19-183	Nut - Wing		7-364	Bracket - Yoke L.H.
20	6-63	Yoke	59	20-287	Screw
21	17-2	Clamp - Cable	60	10-208	Cover
22	21-18	Washer	61	18-3	Screw
23	18-36	Bolt - Engine	62	130-25	Chute Extension
24	28-90	Pin - Cotter	63	18-127	Bolt - Carriage
25	21-146	Washer - Flat	64	20-74	Bolt - Axle
26	101-84	Pinion	65	3-168	Wheel - 8" Plastic
27	137-15	Cap - Protective	66	21-33	Washer
28	22-114	Baffle - Front	67	19-141	Nut
29	26-106	Spacer	68	19-3	Nut
30	28-23	Pin - Roll	69	19-139	Nut - Flange
31	102-138	Shaft	70	2-202	Housing
32	26-107	Spacer	71	20-288	Bolt
33	7-381	Bracket - R.H.	72	19-1	Nut - Keps
34	18-1	Bolt	73	20-156	Bolt
35	26-115	Spacer	74	19-145	Nut - Flange
36	25-96	Tube - Pinion	75	16-1	Key - Engine Shaft
37	18-16	Bolt	76	15-21	Adapter - Blade
38	12-165	Plate - Bearing	77	1-111	Blade
39	11-145	Bearing	78	26-97	Spacer - Blade
40	28-50	Pin - Roll	79	28-110	Roll Pin

OPTIONAL ACCESSORY
 30-0200 Grass Catcher
 30-0250 Replacement bag for 30-0200

*Following models have safety start module on handle control instead of mower housing.
 See inset illustration page 1-304 for correct part numbers:

Model No.	Serial Numbers
10ASP216	186526 thru 187000 190001 thru 190703