

REPAIR PARTS FOR MODEL 45-0238 BROADCAST SPREADER (TRACTOR MOUNT)

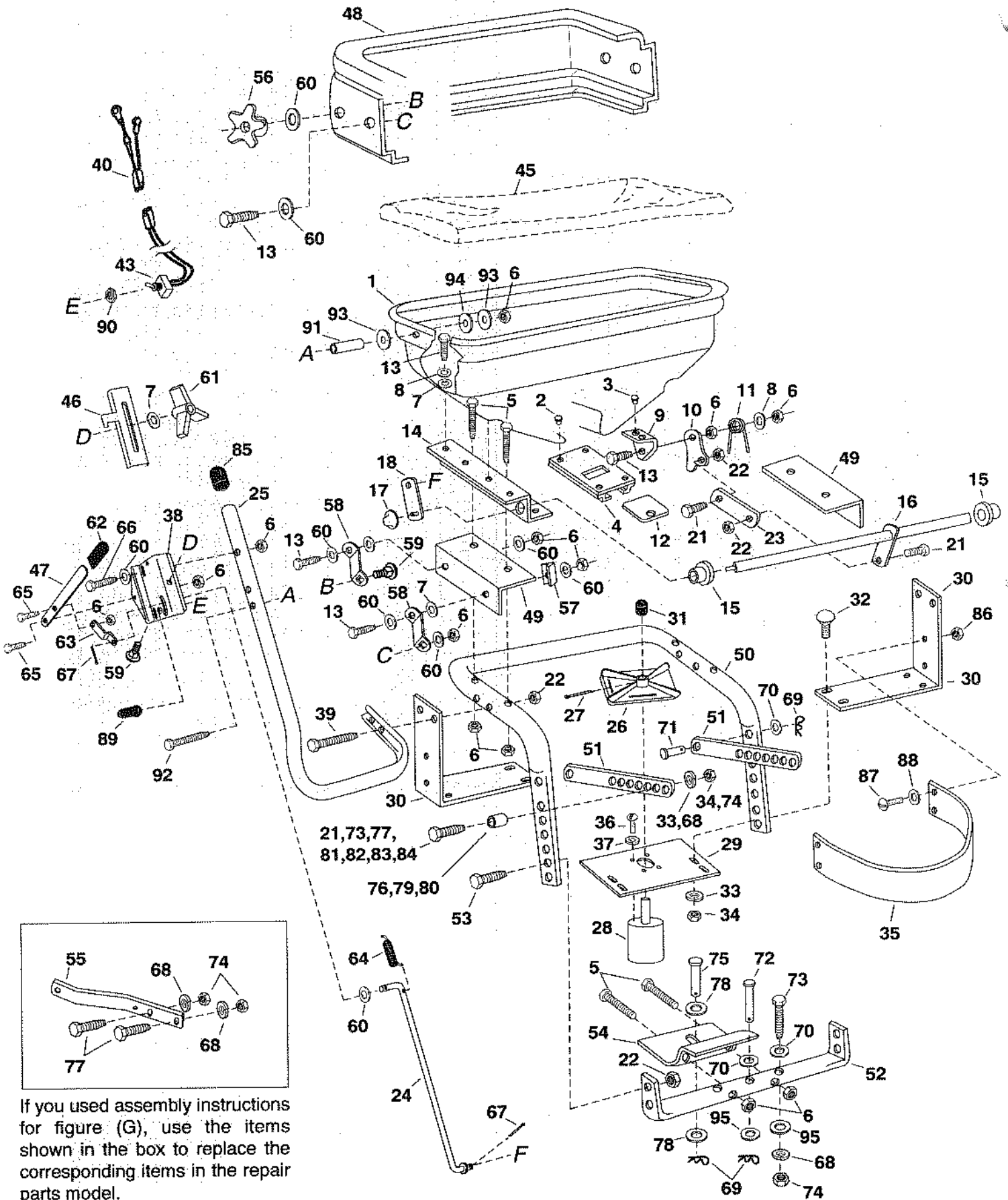

If you used assembly instructions for figure (G), use the items shown in the box to replace the corresponding items in the repair parts model.

REPAIR PARTS LIST FOR MODEL 45-0238 BROADCAST SPREADER (TRACTOR MOUNT)

REF NO.	PART NO.	QTY.	DESCRIPTION	REF NO.	PART NO.	QTY.	DESCRIPTION
1	44466	1	Hopper	50	45193	1	Tube, Frame
2	43882	4	Rivet, Stainless	51	23931	2	Strap, Mount Adjust
3	C-9M5732	2	Rivet, Pop	52	45194	1	Tube, Crossover
4	63081	1	Ass'y, Guide Closure	53	43063	4	Bolt, Hex 5/16-18 x 1" Lg. Gr. 5
5	1509-69	6	Bolt, Hex 1/4-20 x 1-3/4" Lg. Gr. 5	54	23932	1	Bracket, Hitch
6	43013	23	Nut, Hex Lock 1/4-20	55	23933	2	Bar, Hitch
7	1543-69	9	Washer, Nylon 21/64	56	46120	2	Knob, Plastic 1/4-20 Threads
8	43088	5	Washer, 1/4" Std. Wrt.	57	23999	2	Bracket, Angle Stop
9	23753	1	Bracket, Gate Slide Angle	58	23998	4	Bracket, Shield Swivel
10	23758	1	Bracket, Slide Gate	59	44950	3	Bolt, Carriage 1/4-20 x 3/4" Lg.
11	46312	1	Spring, Torsion	60	R19111116	17	Washer, 5/16" SAE
12	23533	1	Plate, Closure	61	43849	1	Knob, Plastic 1/4-20 Threads
13	43012	11	Bolt, Hex 1/4-20 x 3/4" Lg. Gr. 5	62	43848	1	Grip, Control Arm
14	24048	2	Bracket, Hopper Mounting	63	23756	1	Link, Flow Control
15	741-0248	2	Bearing, Flange	64	46317	1	Spring, Extension
16	63080	1	Ass'y, Flow Control Pivot Rod	65	43866	2	Bolt, Hex 1/4-20 x 5/8" Lg. Gr. 5
17	44166	1	Nut, Cap Push 1/2"	66	43648	2	Bolt, Hex 1/4-20 x 1-1/2" Lg. Gr. 5
18	24050	1	Link, Pivot Rod	67	44101	2	Pin, Cotter 3/32" x 3/4" Lg.
19	45093	2	Ratchet, Rivet (Male)	68	43003	4	Lock Washer 3/8"
20	45094	2	Ratchet, Rivet (Female)	69	43055	3	Hairpin Cotter 3/32"
21	43182	4	Bolt, Hex 5/16-18 x 3/4" Lg. Gr. 5	70	43070	4	Washer, 3/8" Std. Wrt.
22	43064	10	Nut, Hex Lock 5/16-18	71	45091	2	Pin, Clevis 3/8" x 1"
23	24051	1	Link, Pivot Rod	72	43023	1	Pin, Clevis 3/8" x 2"
24	46300	1	Rod, Flow Control	73	43432	2	Bolt, Hex 3/8-16 x 2-1/2" Lg. Gr. 5
25	46301	1	Control Tube	74	43015	4	Nut, Hex 3/8"
26	04367	1	Spreader Plate	75	44049	1	Pin, Clevis 1/2" x 1-1/4" Lg.
27	43010	1	Pin, Cotter 1/8" x 1-1/4" Lg.	76	23625	4	Pivot Bushing 1/4" Lg.
28	46259	1	Motor, 12 Volt	77	43001	4	Bolt, Hex 3/8-16 x 1" Lg. Gr. 5
29	24053	1	Plate, Motor Mount	78	R19171616	2	Washer 1/2"
30	24052	2	Bracket, Motor Mount	79	23519	2	Spacer, 9/16" x 11/32" Lg.
31	44688	1	Cap, Vinyl 3/4"	80	23228	4	Spacer, Hitch Frame 3/4" Lg.
32	43080	4	Bolt, Carriage 5/16-18 x 3/4" Lg.	81	43062	2	Bolt, Hex 3/8-16 x 1-1/2" Lg. Gr. 5
33	43086	10	Lock Washer 5/16"	82	43840	4	Bolt, Hex 5/16-18 x 1-1/4" Lg. Gr. 5
34	43083	10	Nut, Hex 5/16"	83	43085	2	Bolt, Hex 5/16-18 x 1-1/2" Lg. Gr. 5
35	46303	1	Deflector, Rear Plastic	84	41576	2	Bolt, Hex 3/8-16 x 1-3/4" Lg. Gr. 5
36	46334	4	Bolt, Sl. Pan Hd. 8-32 x 1/2" Lg.	85	44481	1	Cap Vinyl 1"
37	736-0722	4	Lock Washer 3/16"	86	43662	4	Nut, Hex 10-32
38	23754	1	Bracket, Flow Control Mount	87	43346	4	Bolt, Sl. Pan Hd. 10-32 x 1/2" Lg.
39	44180	4	Bolt, Hex 5/16-18 x 2" Lg. Gr. 5	88	43910	4	Washer, Flat #10
40	45018	1	Connector With Wire	89	45082	1	Boot, Rubber Switch
41	45085	1	Terminal, .25 Male Tab	90	45048	1	Nut, Hex 15/32-32
42	45086	1	Terminal, .25 Female Tab	91	23906	1	Spacer, 1-9/16" Lg.
43	46304	1	Switch, On - Off (Spring Loaded)	92	46071	1	Bolt, Hex 1/4-20 x 3-1/4" Lg. Gr. 5
44	726-0178	5	Tie, Nylon	93	43572	2	Washer, 1-1/2" O.D.
45	43962	1	Cover, Hopper Vinyl	94	43553	1	Washer, Nylon 1-1/2" O.D.
46	23755	1	Gage, Flow Control	95	43352	2	Flat Washer, 7/16"
47	23759	1	Arm Flow Control		46306	1	Owners Manual
48	46119	1	Hopper Guard				
49	23997	2	Bracket, Shield				